

Typical 200l Rainwater Butt

NTS

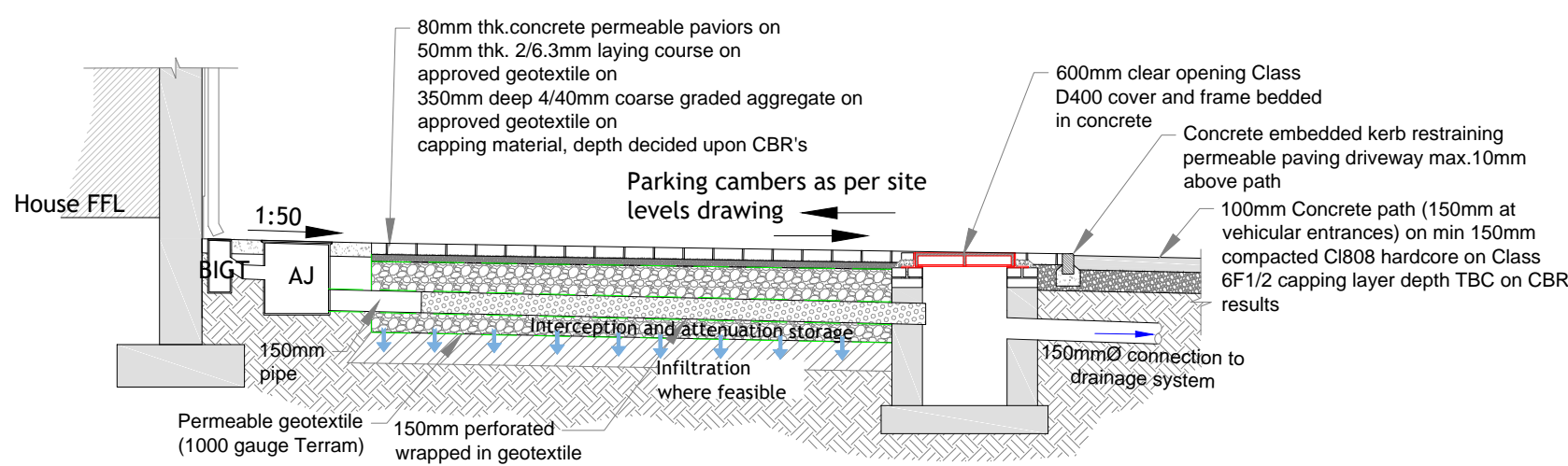

Typical Private Parking Bay

Scale 1:50

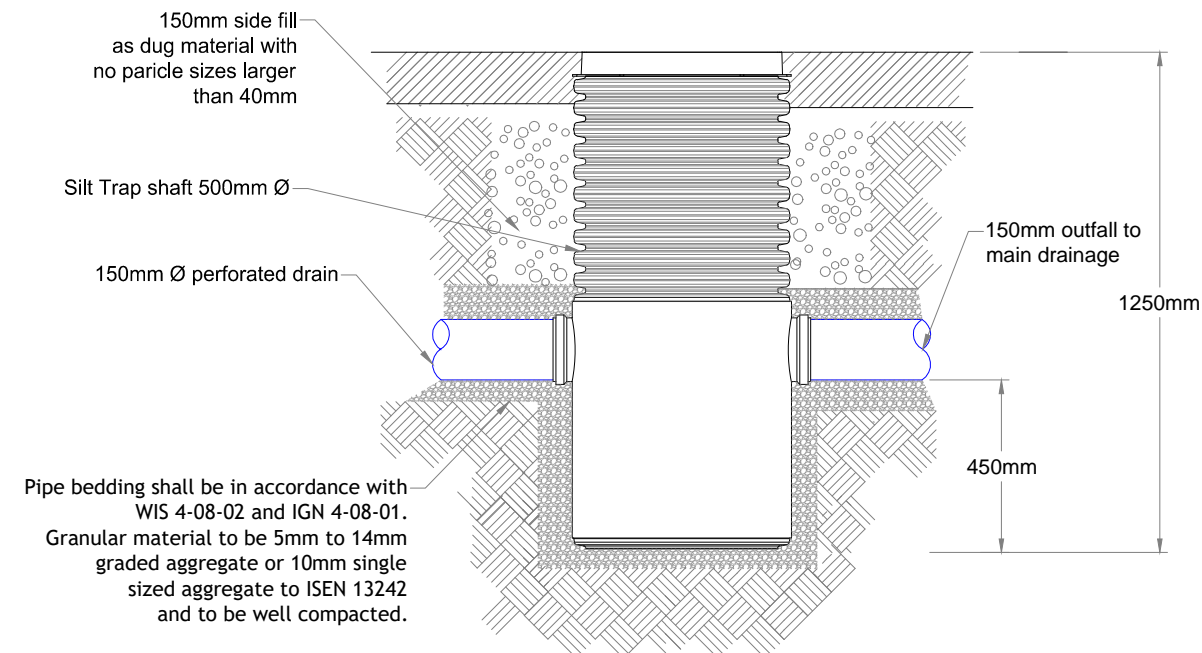

Silt-Trap Chamber at Swales and Filter Trenches

Scale: 1:20.

NOTES:

1. Read in conjunction with all relevant Architect's and Engineer's drawings.
2. Do not set out from this drawing. Setting out to be done from Architect's drawings.
3. Manhole and road gully details to comply with Greater Dublin Regional Code of practice for Drainage Works.
4. All pipes up to and including 150mm to be Wavin Tritec laid in accordance with IAB building products certification. Minimum fall 1/80 UNO. House drains to be laid a minimum of 5m from rear of house, UNO.
5. All pipes 225mm and over to be S&S concrete with rubber rings, laid on a 150mm concrete bed and haunched or surrounded.
6. Where cover to pipes is less than 1.2m in roads, 1.0m in public areas and 0.8m in grassed/landscaped areas, surround the pipe up to 150mm with 100mm concrete and larger pipes with 150mm Concrete.
7. Back-fill trenches in roads to detail.
8. Adjust foundation depths, as necessary, adjacent to sewers to avoid undermining of the foundations.
9. Manhole covers and frames shall comply with the LA standard pattern with min opening of 600mm & with closed keyways, all Manholes covers to comply with IS EN 124:1994. Group 4 (min. class D400) manholes in all trafficked areas, Minimum Group 2 (min. class B125) to be used in footpaths, pedestrian areas and comparable areas, Class D400 should be used in footpaths where heavy vehicles have the potential to access or mount footpaths and these covers should be free of trip hazards, removable parts and be lockable, an example of suitable cover type is a Cavanagh Brozna, supplied by Cavanagh Foundry Ltd. Group 1 (min. class A15) may be used in enclosed private gardens only.
10. Manholes on house drains to be in private property. House drains shall not pass through property they do not serve.
11. Double gullies, with separate connections to main, to be provided at low points and at the ends of Cul de Sacs. Maximum run of pipe 15m. Minimum pipe diameter 150mm. Maximum gully spacing for roads up to 7m wide to be 50m UNO.
12. All Road gullies to be closed in the direction of traffic flow.
13. All Gully tops shall comply with the LA standard. Group 3 (min. class C250) where gully are located in the kerbside channels of roads which when measured from the kerb, extend a maximum of 0.5m into the carriageway and a maximum of 0.2m into the footway. Group 4 (min Class D400) to be used elsewhere. All gully covers to comply with IS EN 124:1994
14. Record drawings of the as constructed work shall be made available to RMA at the end of the project.
15. All connections to existing public services must be determined by the main contractor prior to any construction on site. All existing invert levels to be confirmed to the engineers and all discrepancies notified to RMA before any construction commences.

REFER TO DWG. No. 2411/108 FOR MANHOLE DETAILS

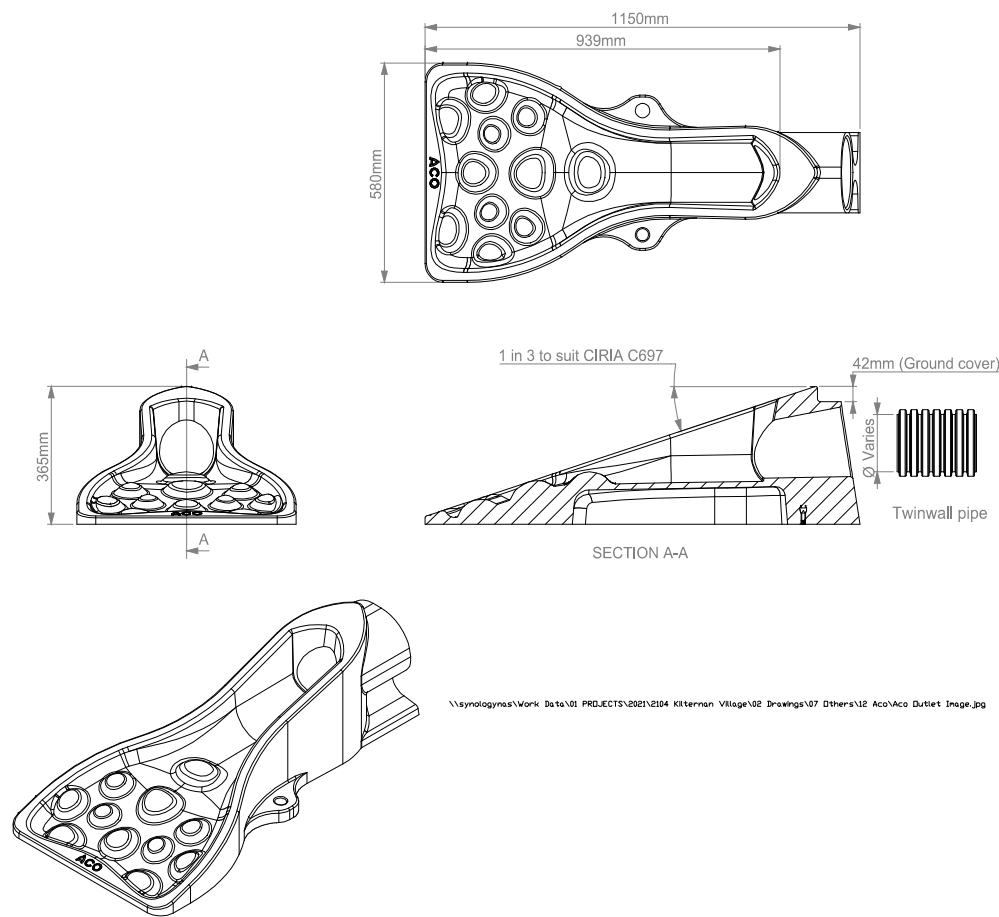

Typical ACO Proprietary SuDS Swale Inlet

Scale 1:20

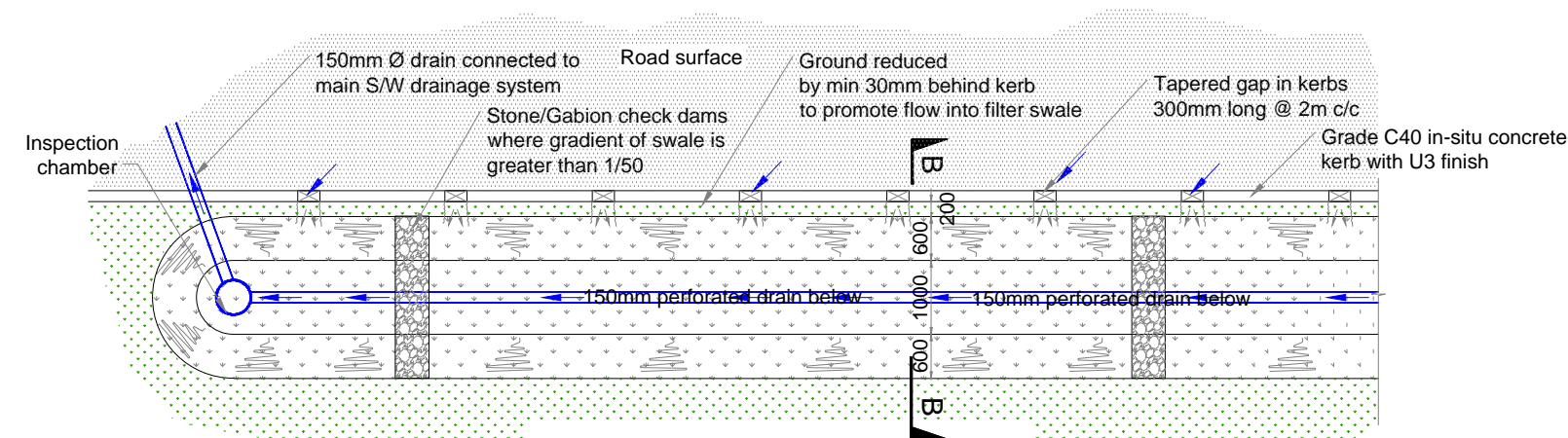

Typical Plan of Filter Swale

Scale 1:100

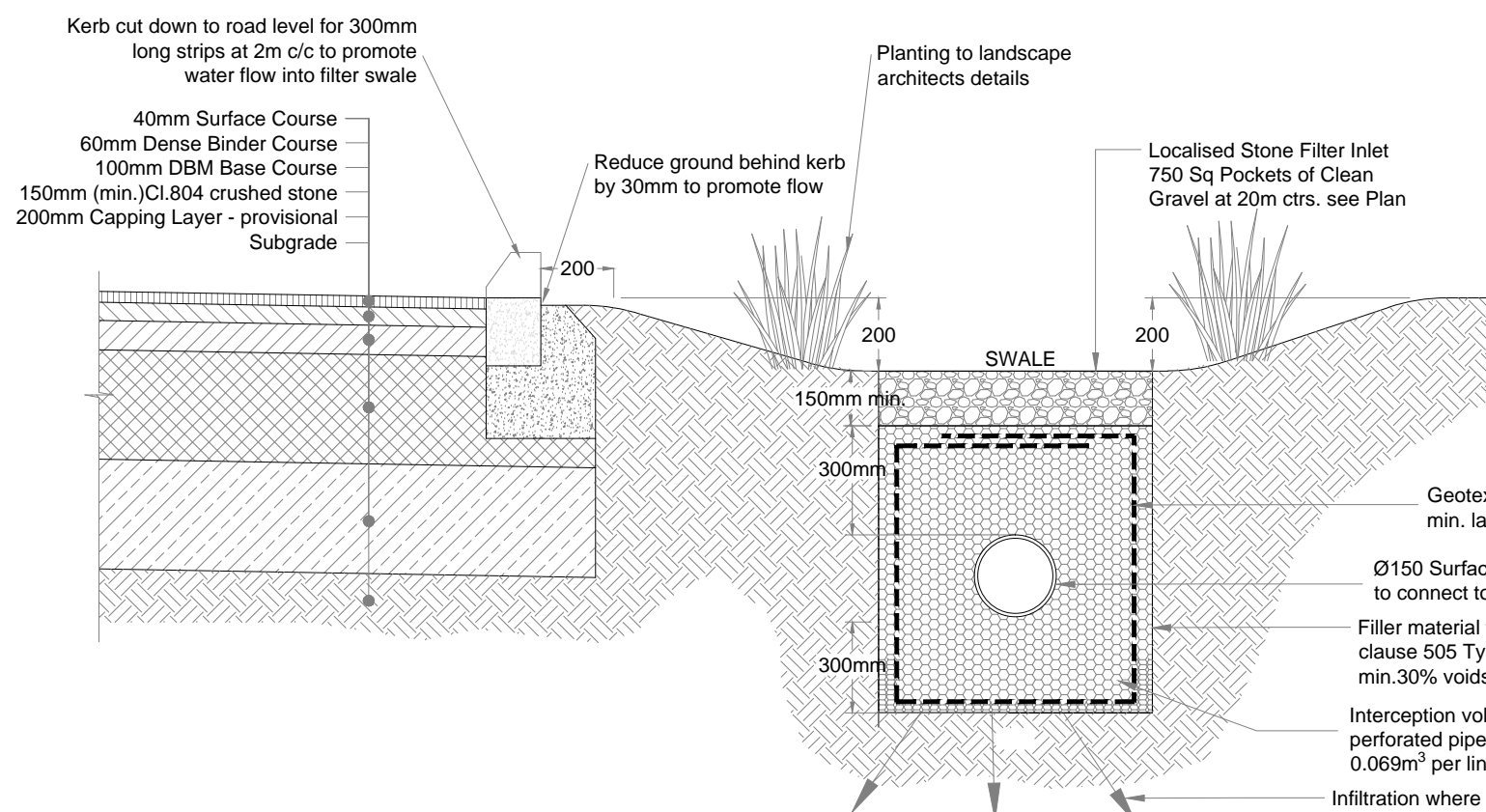

Section B-B

Typical Filter Swale Section

Scale 1:20

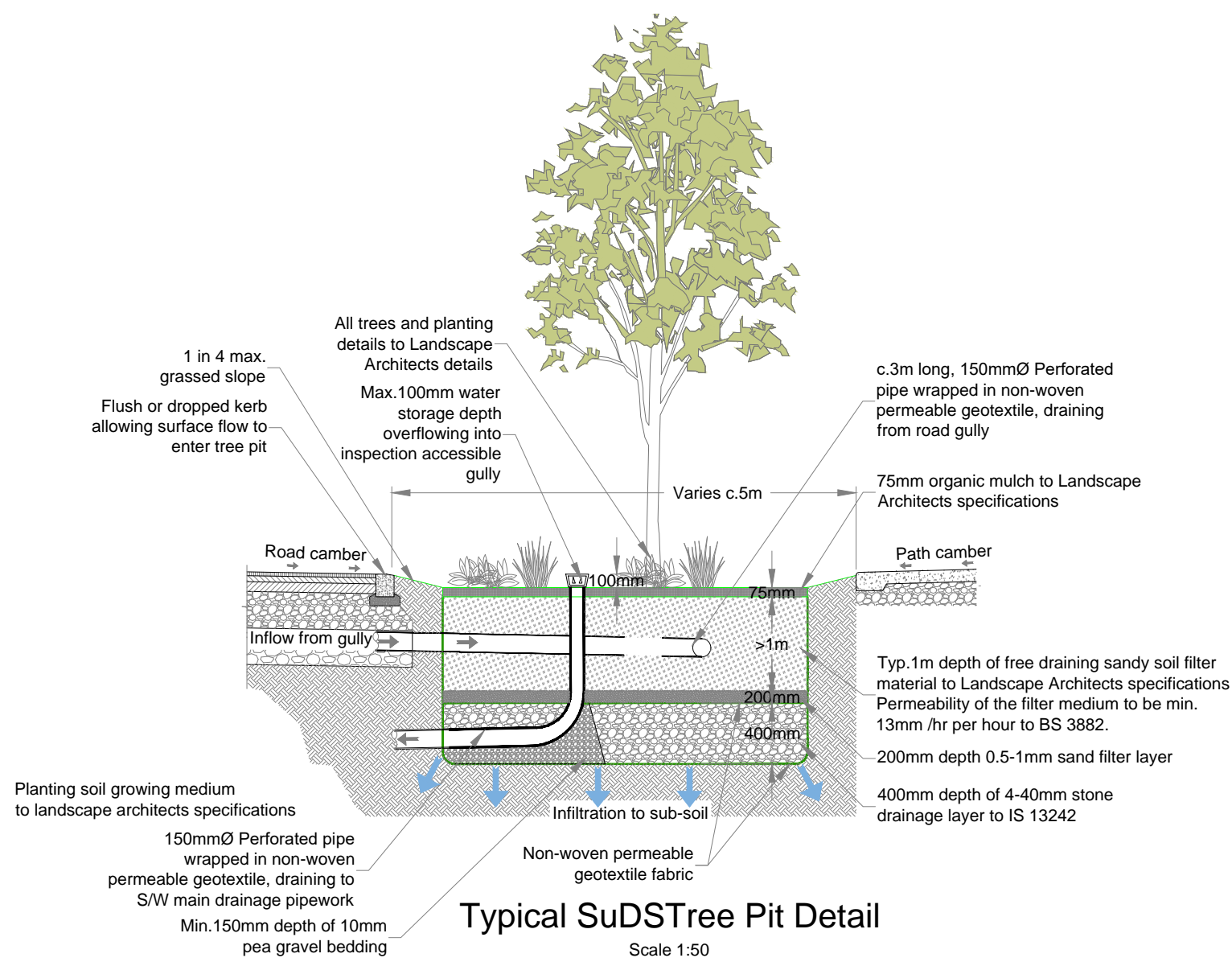

Typical SuDSTree Pit Detail

Scale 1:50

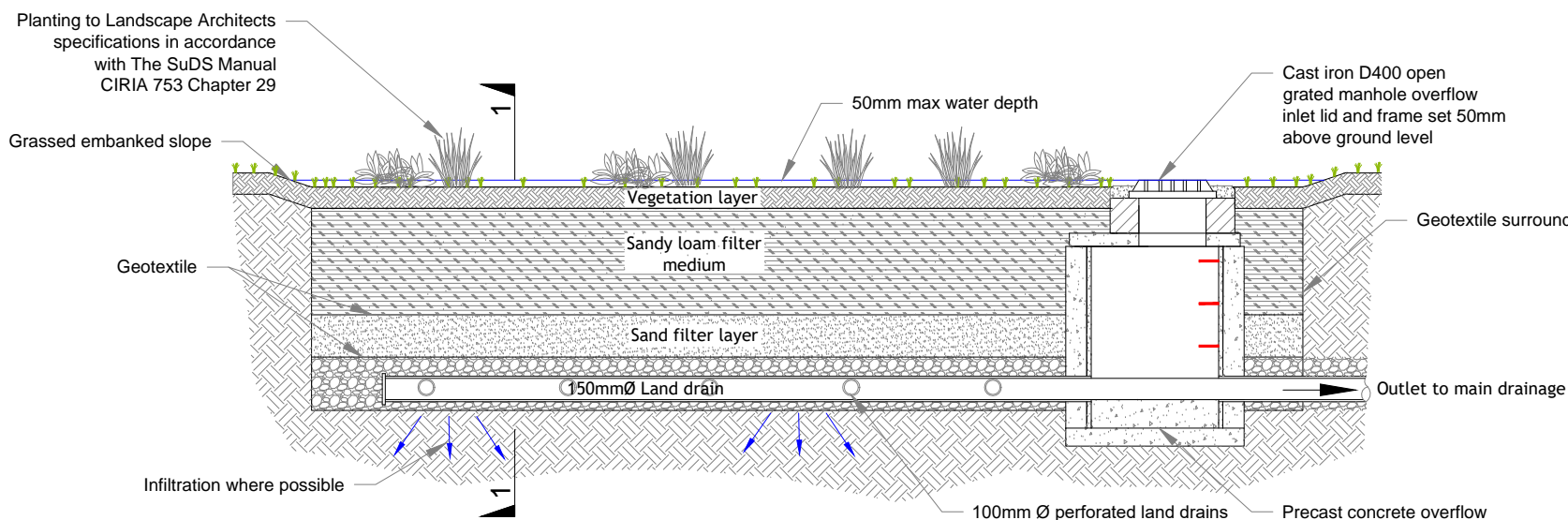

Typical Bio-Retention Area

Long' Section

Scale 1:50

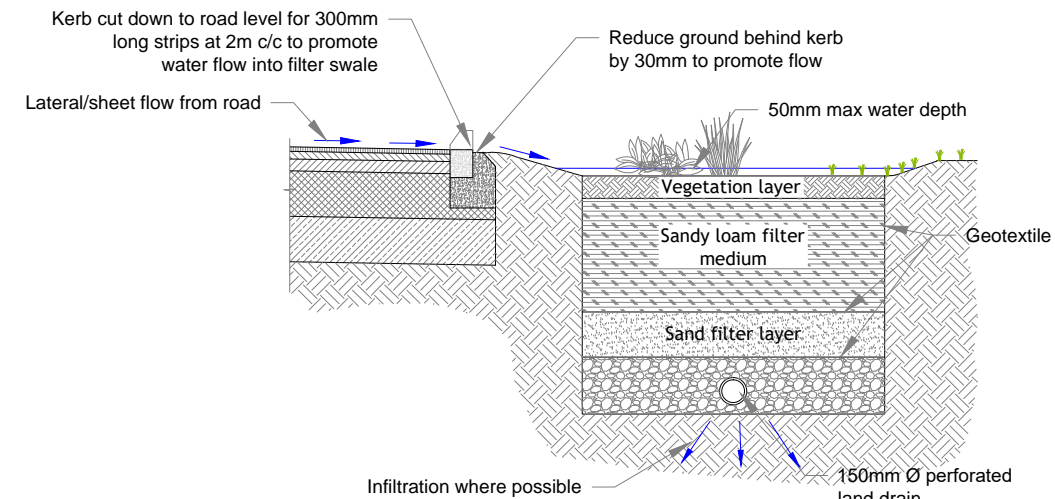

Section 1-1

Scale 1:50

REV DATE DESCRIPTION

ROGER MULLARKEY & ASSOCIATES
Consulting Structural and Civil Engineers

Duncreevan, Kilcock, Co. Kildare
Tel: +353 1 610 3755 Mob: +353 87 232 4917
E-mail: info@rmullarkey.ie www.rmullarkey.ie

Project					
GLENAMUCK NORTH					
Drawing Title				Architect	
SuDS Details				MCORM	
Date	Drawn By	Scales	Dwg.No.	Stage	Rev
Feb'25	RM	As Shown @ A1	2411/105	LRD Stage 3	